

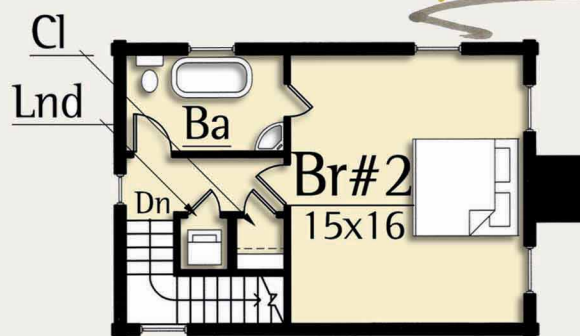

MIDDLEBURG

1,224 total square feet

The Middleburg Camp is a 1,224 s.f. re-creation of America's Appalachian past. The design is curiously primitive in the same manner as the original Appalachian cabins. In the interior, the layout is a simple two bedroom cabin with an open living/ kitchen/ dining area; perfect for a weekend getaway or a guest house.



Upper Level
468 square feet

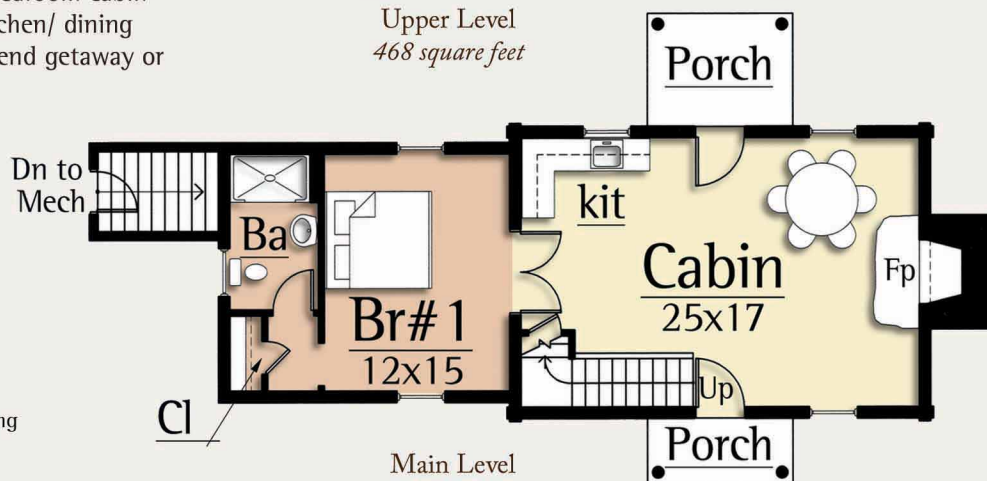

Main Level
756 square feet

Legend

- Timber Framing
- Log Framing



MIDDLEBURG

1,224 total square feet

The Middleburg Camp is a 1,224 s.f. re-creation of America's Appalachian past. The design is curiously primitive in the same manner as the original Appalachian cabins. In the interior, the layout is a simple two bedroom cabin with an open living/ kitchen/ dining area; perfect for a weekend getaway or a guest house.

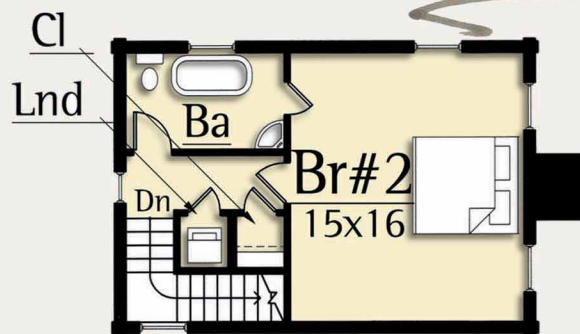

Upper Level
468 square feet

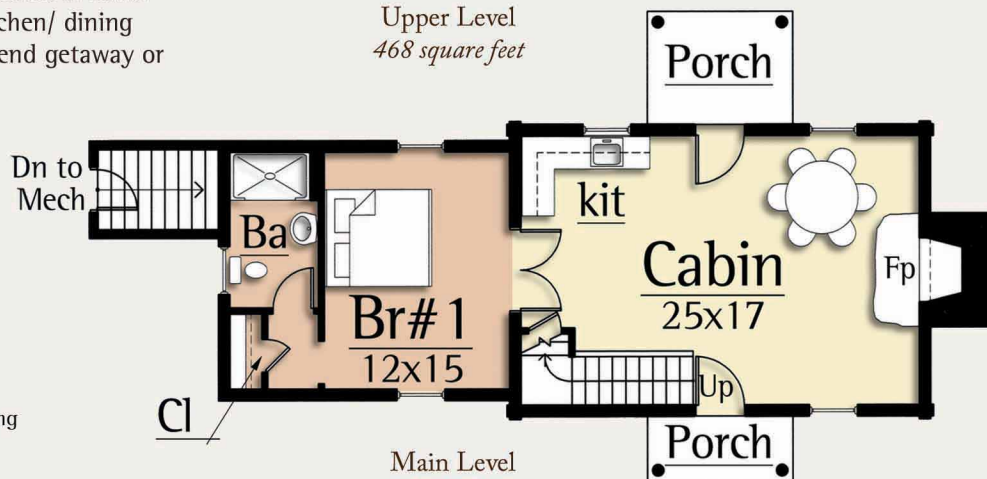

Main Level
756 square feet

Legend

- Timber Framing
- Log Framing

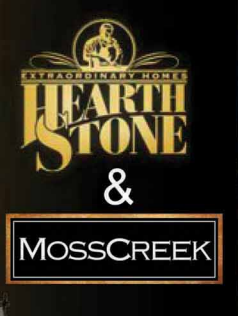

MIDDLEBURG

1,224 total square feet

The Middleburg Camp is a 1,224 s.f. re-creation of America's Appalachian past. The design is curiously primitive in the same manner as the original Appalachian cabins. In the interior, the layout is a simple two bedroom cabin with an open living/ kitchen/ dining area; perfect for a weekend getaway or a guest house.

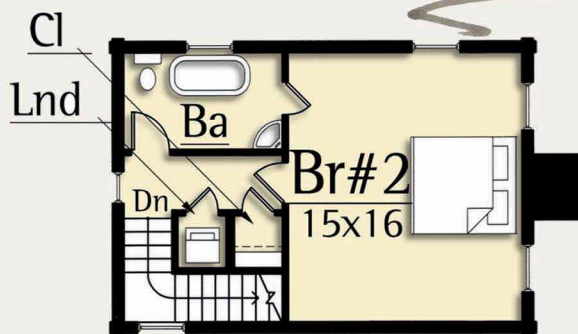

Upper Level
468 square feet

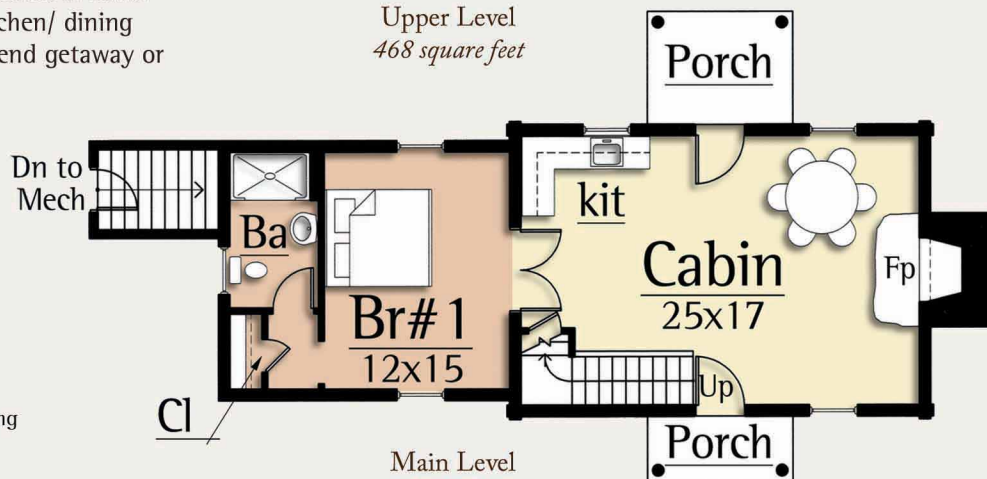

Main Level
756 square feet

Legend

- Timber Framing
- Log Framing

EXTRAORDINARY HOMES

www.HearthstoneHomes.com 1.800.247.4442

RUSTIC AMERICAN HOME DESIGN

www.MossCreek.net 800.737.2166



MIDDLEBURG

1,224 total square feet

The Middleburg Camp is a 1,224 s.f. re-creation of America's Appalachian past. The design is curiously primitive in the same manner as the original Appalachian cabins. In the interior, the layout is a simple two bedroom cabin with an open living/ kitchen/ dining area; perfect for a weekend getaway or a guest house.

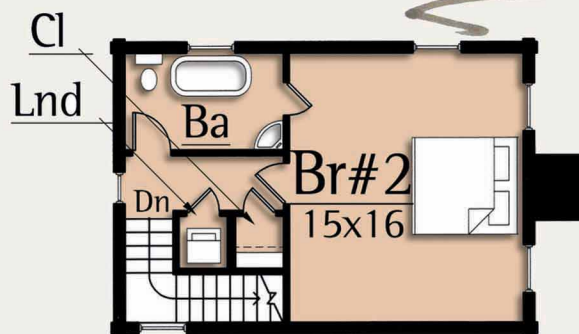

Upper Level
468 square feet

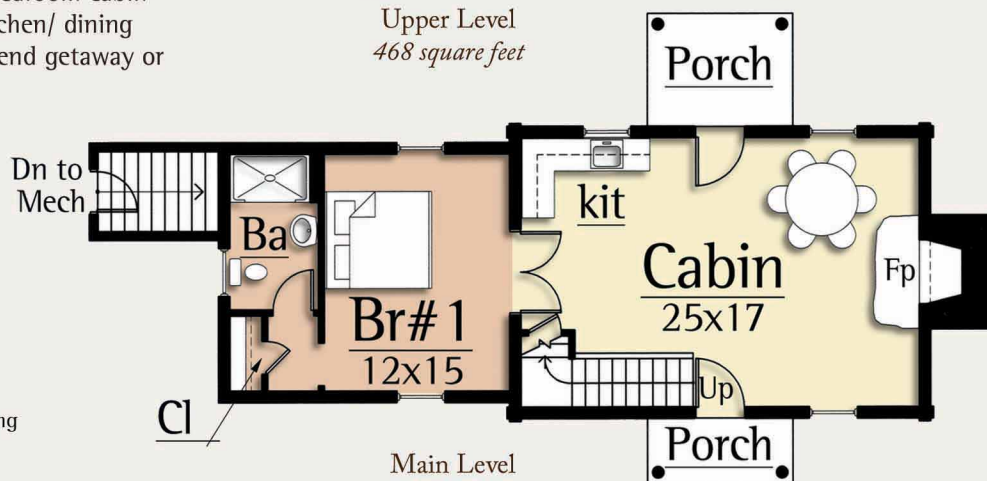

Main Level
756 square feet

Legend

- Timber Framing
- Log Framing

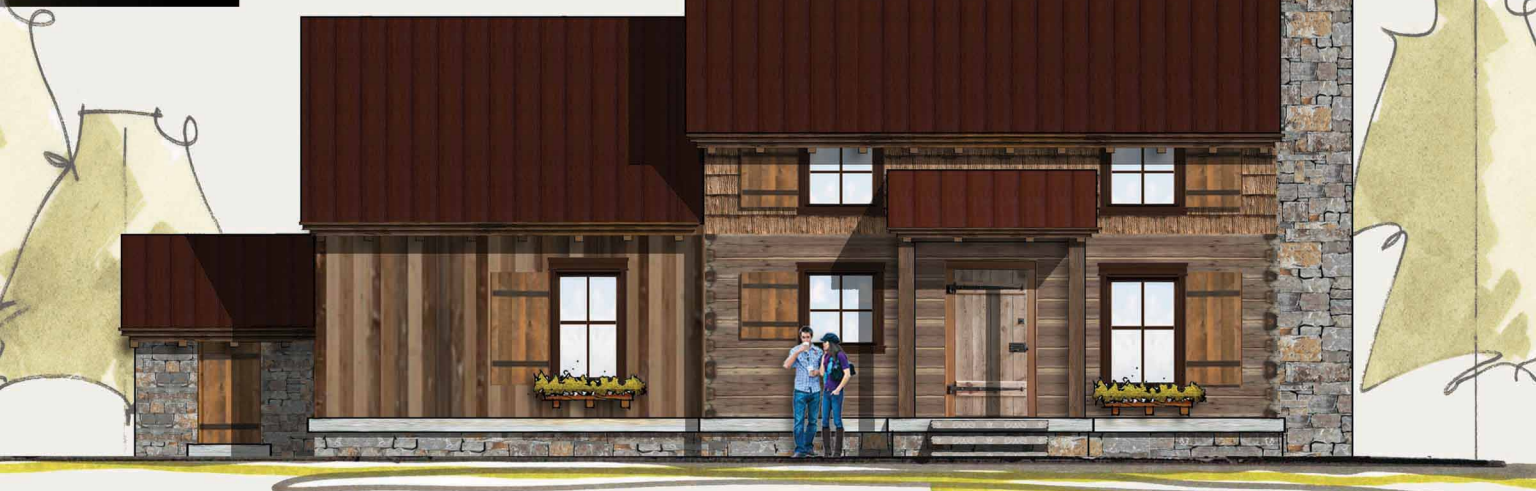

MIDDLEBURG

1,224 total square feet

The Middleburg Camp is a 1,224 s.f. re-creation of America's Appalachian past. The design is curiously primitive in the same manner as the original Appalachian cabins. In the interior, the layout is a simple two bedroom cabin with an open living/ kitchen/ dining area; perfect for a weekend getaway or a guest house.

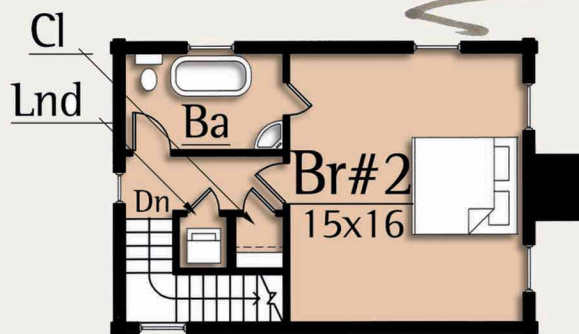

Upper Level
468 square feet

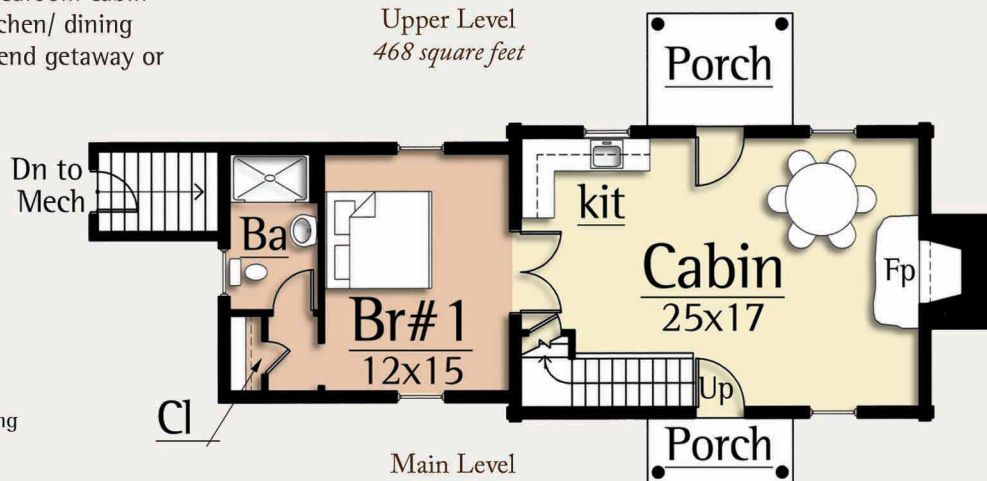

Main Level
756 square feet

Legend

- Timber Framing
- Log Framing



MIDDLEBURG

1,224 total square feet

The Middleburg Camp is a 1,224 s.f. re-creation of America's Appalachian past. The design is curiously primitive in the same manner as the original Appalachian cabins. In the interior, the layout is a simple two bedroom cabin with an open living/ kitchen/ dining area; perfect for a weekend getaway or a guest house.

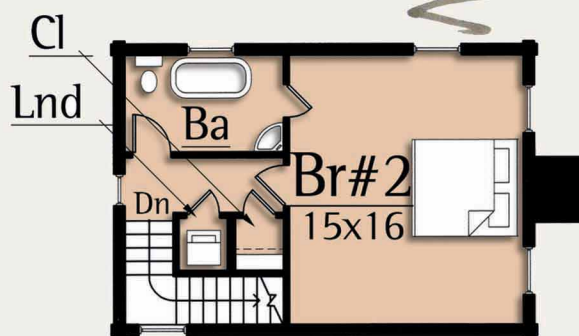

Upper Level
468 square feet

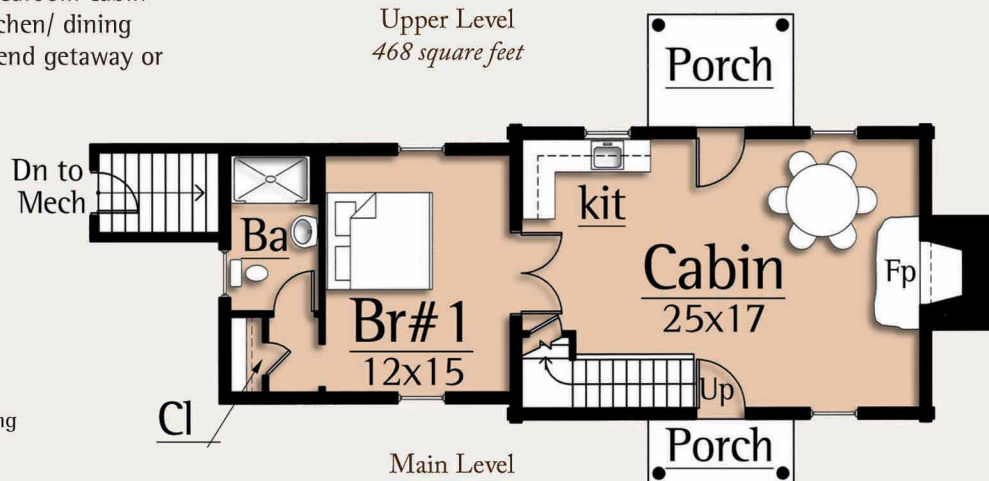

Main Level
756 square feet

Legend

 Timber Framing



MIDDLEBURG

1,224 total square feet

The Middleburg Camp is a 1,224 s.f. re-creation of America's Appalachian past. The design is curiously primitive in the same manner as the original Appalachian cabins. In the interior, the layout is a simple two bedroom cabin with an open living/ kitchen/ dining area; perfect for a weekend getaway or a guest house.

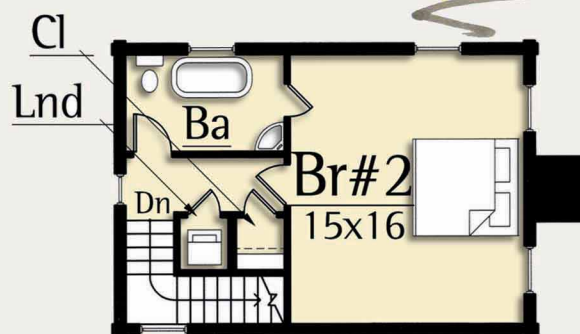

Upper Level
468 square feet

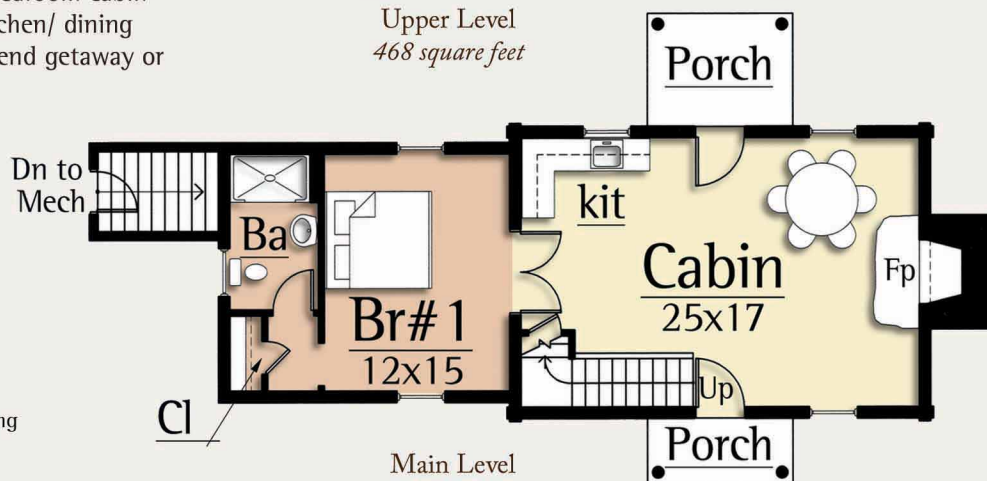

Main Level
756 square feet

Legend

- Timber Framing
- Log Framing



MIDDLEBURG

1,224 total square feet

The Middleburg Camp is a 1,224 s.f. re-creation of America's Appalachian past. The design is curiously primitive in the same manner as the original Appalachian cabins. In the interior, the layout is a simple two bedroom cabin with an open living/ kitchen/ dining area; perfect for a weekend getaway or a guest house.

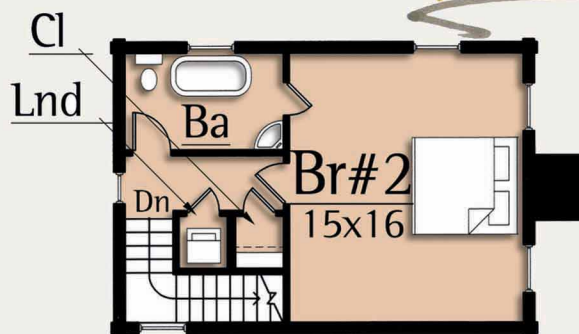

Upper Level
468 square feet

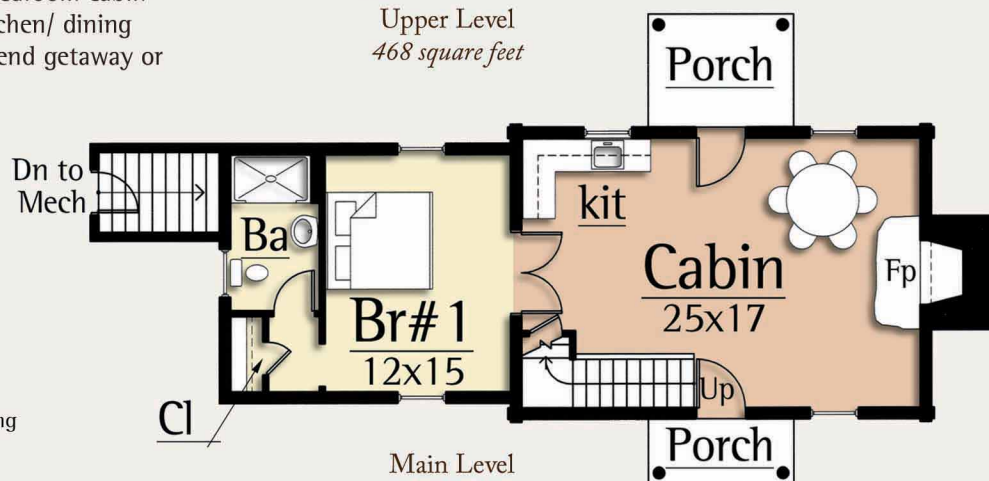

Main Level
756 square feet

Legend

- Timber Framing
- Log Framing



MIDDLEBURG

1,224 total square feet

The Middleburg Camp is a 1,224 s.f. re-creation of America's Appalachian past. The design is curiously primitive in the same manner as the original Appalachian cabins. In the interior, the layout is a simple two bedroom cabin with an open living/ kitchen/ dining area; perfect for a weekend getaway or a guest house.

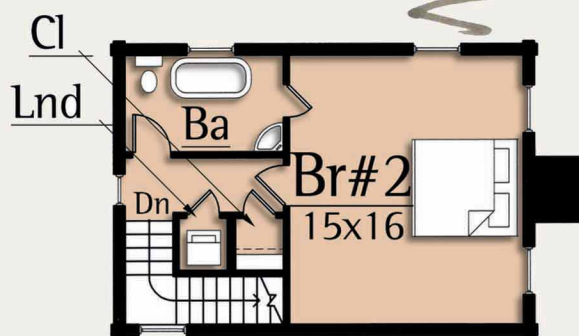

Upper Level
468 square feet

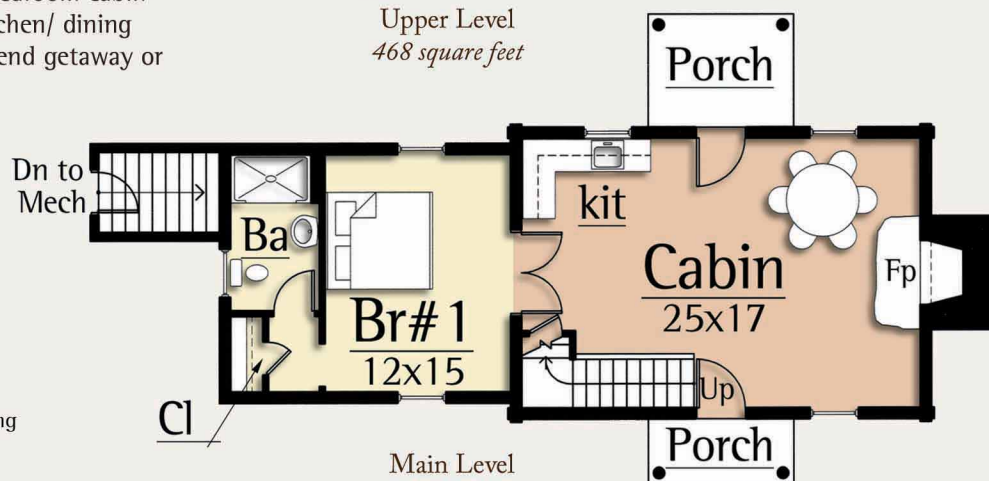

Main Level
756 square feet

Legend

- Timber Framing
- Log Framing



MIDDLEBURG

1,224 total square feet

The Middleburg Camp is a 1,224 s.f. re-creation of America's Appalachian past. The design is curiously primitive in the same manner as the original Appalachian cabins. In the interior, the layout is a simple two bedroom cabin with an open living/ kitchen/ dining area; perfect for a weekend getaway or a guest house.

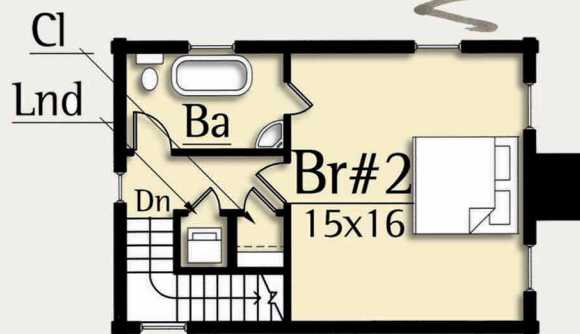

Upper Level
468 square feet

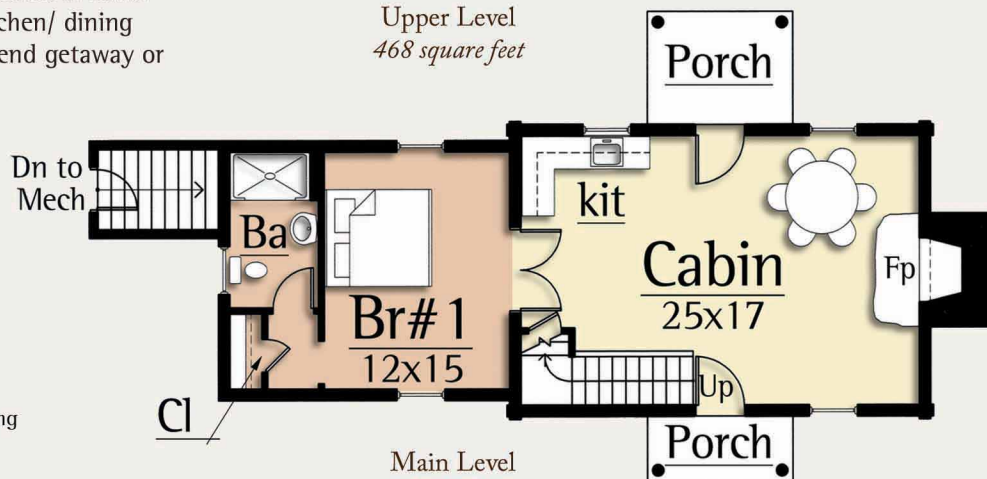

Main Level
756 square feet

Legend

- Timber Framing
- Log Framing